

PAYMENT SCHEDULE

SAPPHIRE

TYPE A

5 Rooms

DESCRIPTION	AMOUNT
ON BOOKING	950,000
ON CONFIRMATION (AFTER 30 DAYS FROM THE DATE OF BOOKING)	950,000
ON ALLOCATION (AFTER 60 DAYS FROM THE DATE OF BOOKING)	950,000
MONTHLY INSTALMENTS (1 15,000 X 24)	2,760,000
QUARTERLY INSTALMENTS (1 65,000 X 8)	1,320,000
POSSESSION	70,000
CASH PAYABLE	7,000,000

Extra Charges

Road Facing Rs. 250,000/- West Open: Rs. 250,000/- Corner: Rs. 250,000/-

Expected Loan: Rs. 3,500,000/-

Important Notes:

1. All instalments must be paid by the allottee strictly as per schedule agreed by the allottee, from 1st to 10th of each month, and allottee shall abide by the terms and conditions of the booking application form.
2. All extra charges will be payable within 180 days from the date of booking.
3. The allocation of unit shall remain provisional until the company receives full & final payment.
4. Documentation Charges for Lease, loan and connection charges for Gas, Electricity, Water & Sewerage etc. will be charged as extra when demanded by the company, as these charges are not included in the above mentioned cost.

Read, Understood & Accepted

FLOOR PLAN

SAPPHIRE



Type A

PAYMENT SCHEDULE

OPAL

TYPE B

4 Rooms

DESCRIPTION	AMOUNT
ON BOOKING	650,000
ON CONFIRMATION (AFTER 30 DAYS FROM THE DATE OF BOOKING)	650,000
ON ALLOCATION (AFTER 60 DAYS FROM THE DATE OF BOOKING)	650,000
MONTHLY INSTALMENTS (75,000 X 24)	1,800,000
QUARTERLY INSTALMENTS (100,000 X 8)	800,000
ON BLOCK MASONRY	250,000
ON PLASTER	250,000
POSSESSION	250,000
CASH PAYABLE	5,300,000

Extra Charges

Road Facing Rs. 200,000/- West Open: Rs. 200,000/- Corner: Rs. 200,000/-

Expected Loan: Rs. 3,000,000/-

Important Notes:

1. All instalments must be paid by the allottee strictly as per schedule agreed by the allottee, from 1st to 10th of each month, and allottee shall abide by the terms and conditions of the booking application form.
2. All extra charges will be payable within 180 days from the date of booking.
3. The allocation of unit shall remain provisional until the company receives full & final payment.
4. Documentation Charges for Lease, loan and connection charges for Gas, Electricity, Water & Sewerage etc. will be charged as extra when demanded by the company, as these charges are not included in the above mentioned cost.

Read, Understood & Accepted

FLOOR PLAN

OPAL

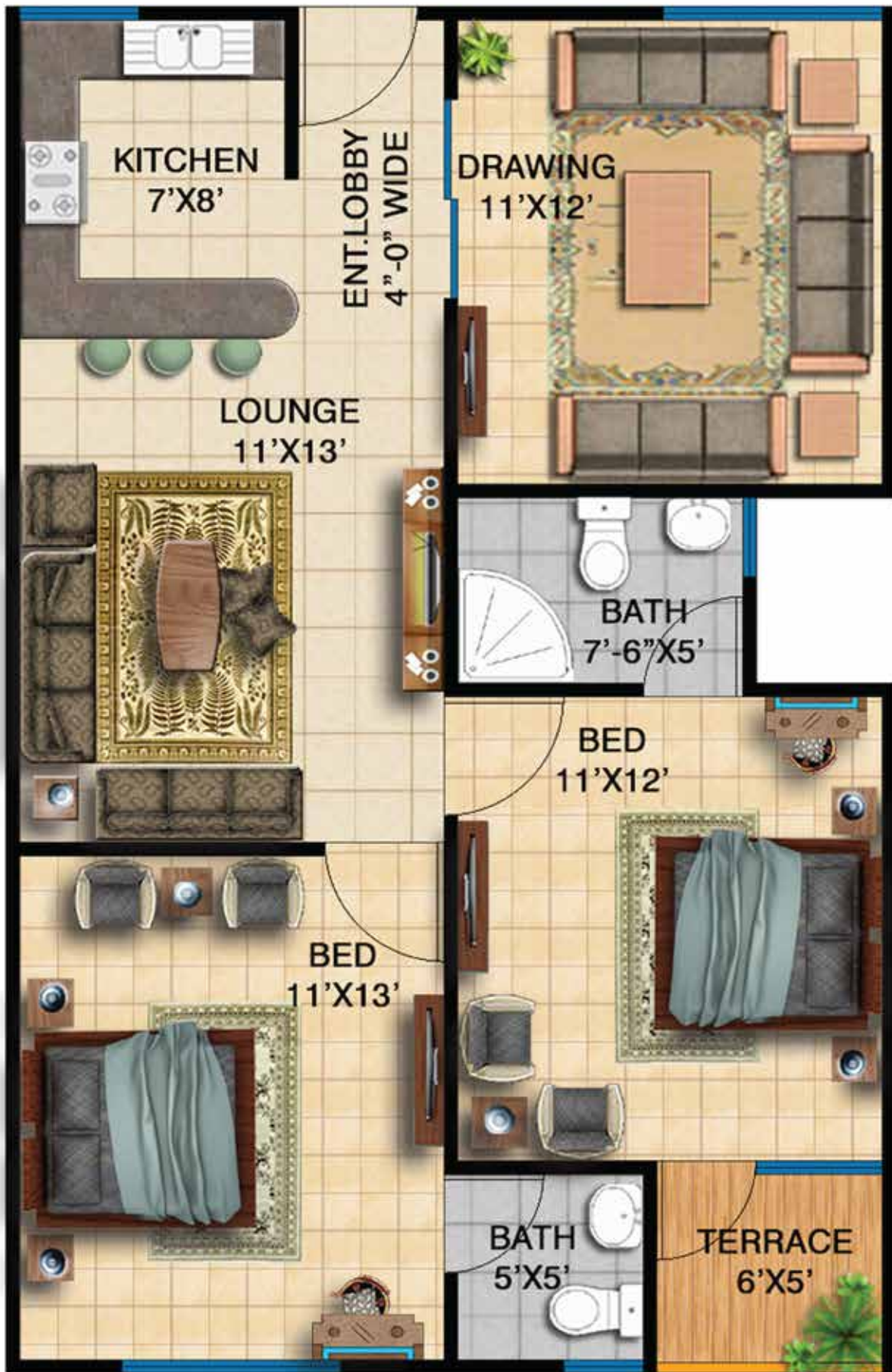

Type B

PAYMENT SCHEDULE

ZIRCON

TYPE C

3 Rooms

DESCRIPTION	AMOUNT
ON BOOKING	475,000
ON CONFIRMATION (AFTER 30 DAYS FROM THE DATE OF BOOKING)	475,000
ON ALLOCATION (AFTER 60 DAYS FROM THE DATE OF BOOKING)	475,000
MONTHLY INSTALMENTS (55,000 X 24)	1,320,000
QUARTERLY INSTALMENTS (97,500 X 8)	780,000
POSSESSION	75,000
CASH PAYABLE	3,600,000

Extra Charges

Road Facing Rs. 150,000/- West Open: Rs. 150,000/- Corner: Rs. 200,000/-

Expected Loan: Rs. 2,000,000/-

Important Notes:

1. All instalments must be paid by the allottee strictly as per schedule agreed by the allottee, from 1st to 10th of each month, and allottee shall abide by the terms and conditions of the booking application form.
2. All extra charges will be payable within 180 days from the date of booking.
3. The allocation of unit shall remain provisional until the company receives full & final payment.
4. Documentation Charges for Lease, loan and connection charges for Gas, Electricity, Water & Sewerage etc. will be charged as extra when demanded by the company, as these charges are not included in the above mentioned cost.

Read, Understood & Accepted

FLOOR PLAN

ZIRCON



Type C

PAYMENT SCHEDULE

EMERALD

Cottage 3 Bed

Type A
Ground & 1st Floor

DESCRIPTION	AMOUNT
ON BOOKING	1,000,000
ON CONFIRMATION (AFTER 30 DAYS FROM THE DATE OF BOOKING)	1,000,000
ON ALLOCATION (AFTER 60 DAYS FROM THE DATE OF BOOKING)	1,000,000
MONTHLY INSTALMENTS (150,000 X 24)	3,600,000
QUARTERLY INSTALMENTS (200,000 X 8)	1,600,000
POSSESSION	100,000
CASH PAYABLE	8,300,000

Extra Charges

Road Facing Rs. 250,000/- West Open: Rs. 250,000/- Corner: Rs. 250,000/-

Expected Loan: Rs. 3,500,000/-

Important Notes:

1. All instalments must be paid by the allottee strictly as per schedule agreed by the allottee, from 1st to 10th of each month, and allottee shall abide by the terms and conditions of the booking application form.
2. All extra charges will be payable within 180 days from the date of booking.
3. The allocation of unit shall remain provisional until the company receives full & final payment.
4. Documentation Charges for Lease, loan and connection charges for Gas, Electricity, Water & Sewerage etc. will be charged as extra when demanded by the company, as these charges are not included in the above mentioned cost.

Read, Understood & Accepted

FLOOR PLAN

EMERALD



Ground & First Floor
Cottage Type A

PAYMENT SCHEDULE

AMBER

Cottage 2 Bed

Type A-2
3rd & 4th Floor

DESCRIPTION

AMOUNT

ON BOOKING	900,000
ON CONFIRMATION (AFTER 30 DAYS FROM THE DATE OF BOOKING)	900,000
ON ALLOCATION (AFTER 60 DAYS FROM THE DATE OF BOOKING)	900,000
MONTHLY INSTALMENTS (100,000 X 24)	2,400,000
QUARTERLY INSTALMENTS (140,000 X 8)	1,120,000
POSSESSION	280,000

CASH PAYABLE

6,500,000

Extra Charges

Road Facing Rs. 200,000/- West Open: Rs. 200,000/- Corner: Rs. 200,000/-

Expected Loan: Rs. 3,000,000/-

Important Notes:

1. All instalments must be paid by the allottee strictly as per schedule agreed by the allottee, from 1st to 10th of each month, and allottee shall abide by the terms and conditions of the booking application form.
2. All extra charges will be payable within 180 days from the date of booking.
3. The allocation of unit shall remain provisional until the company receives full & final payment.
4. Documentation Charges for Lease, loan and connection charges for Gas, Electricity, Water & Sewerage etc. will be charged as extra when demanded by the company, as these charges are not included in the above mentioned cost.

Read, Understood & Accepted

FLOOR PLAN

AMBER



3rd & 4th Floor Cottage Type A-2

PAYMENT SCHEDULE

RUBY

Cottage 2 Bed

Type A-1
2nd Floor

DESCRIPTION

AMOUNT

ON BOOKING	950,000
ON CONFIRMATION (AFTER 30 DAYS FROM THE DATE OF BOOKING)	1,000,000
ON ALLOCATION (AFTER 60 DAYS FROM THE DATE OF BOOKING)	1,000,000
MONTHLY INSTALMENTS (110,000 X 24)	2,640,000
QUARTERLY INSTALMENTS (140,000 X 8)	1,120,000
POSSESSION	290,000

CASH PAYABLE

7,000,000

Extra Charges

Road Facing Rs. 200,000/- West Open: Rs. 200,000/- Corner: Rs. 200,000/-

Expected Loan: Rs. 3,000,000/-

Important Notes:

1. All instalments must be paid by the allottee strictly as per schedule agreed by the allottee, from 1st to 10th of each month, and allottee shall abide by the terms and conditions of the booking application form.
2. All extra charges will be payable within 180 days from the date of booking.
3. The allocation of unit shall remain provisional until the company receives full & final payment.
4. Documentation Charges for Lease, loan and connection charges for Gas, Electricity, Water & Sewerage etc. will be charged as extra when demanded by the company, as these charges are not included in the above mentioned cost.

Read, Understood & Accepted

FLOOR PLAN

RUBY



2nd Floor Cottage Type A-1